

INSTALLATION INSTRUCTIONS



POLE SIDE COVER PSC-4

Hide the pole and wiring between the detectors for tidier appearance.

PARTS IDENTIFICATION

Cover : 2, 4x10 Self tapping : 2, 3x10 Self tapping : 4

1 INTRODUCTION

1 Remove the cap of the PSC-4.

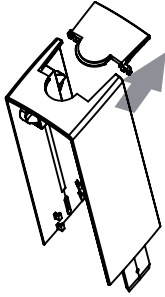

2 Open the notch of mounting pole.

Max.hole diameter 48mm/1.89' (1 1/4 B)
Min.hole diameter 34mm/1.34' (1 1/2 B)

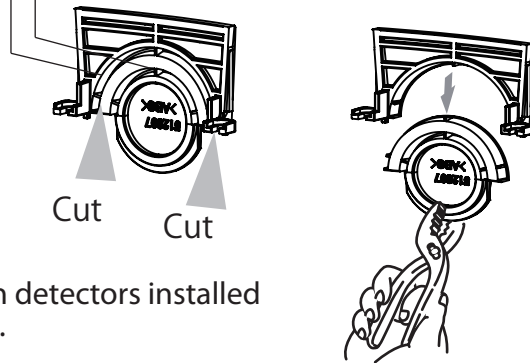

⚠ Caution

When the PSC-4 remove, loosen the screw and then slide the PSC-4.

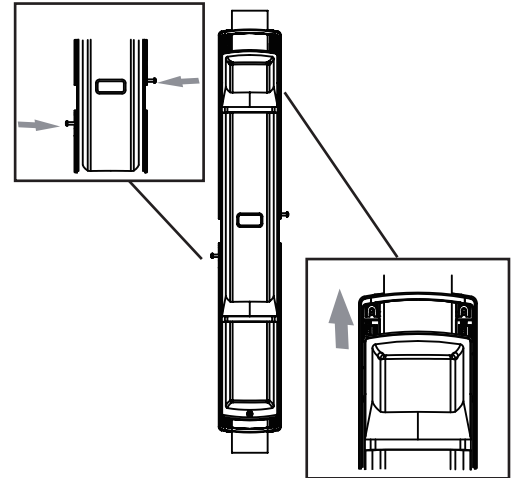

3 Insert the PSC-4 between detectors installed back to back on the pole.

- ① Fix the Cap with the self tapping 3x10
- ② Slide PSC-4 with the pole
- ③ Fix the PSC-4 with the self tapping 4x10

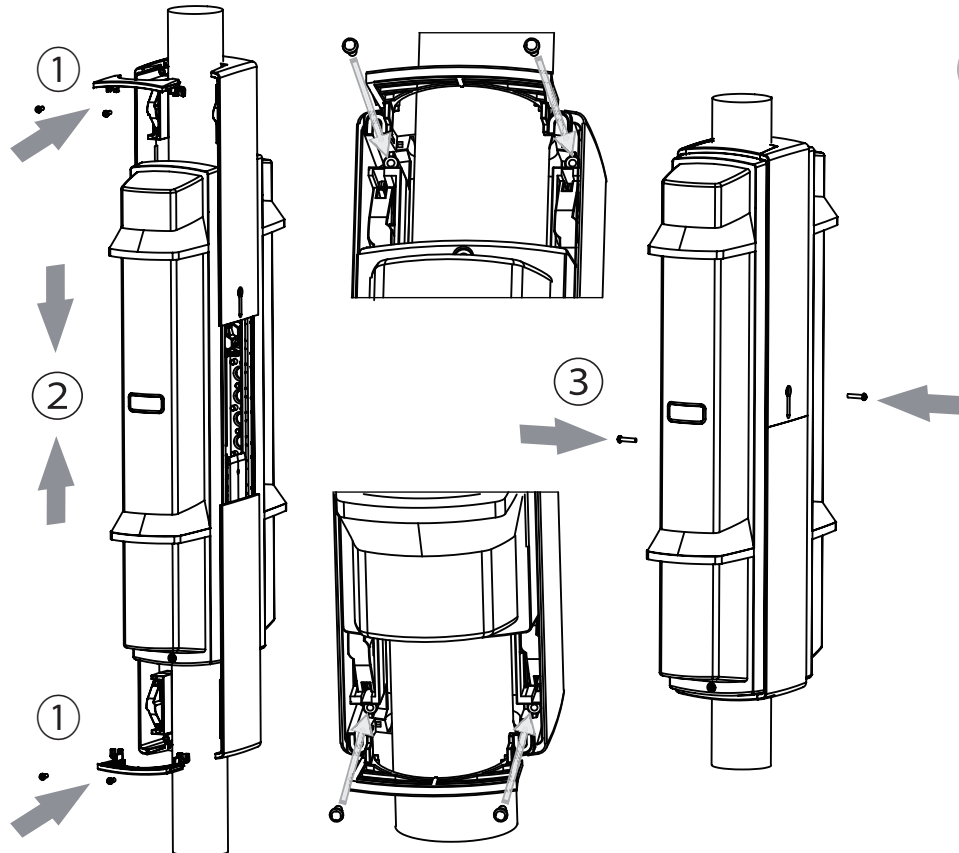

2 DIMENSIONS

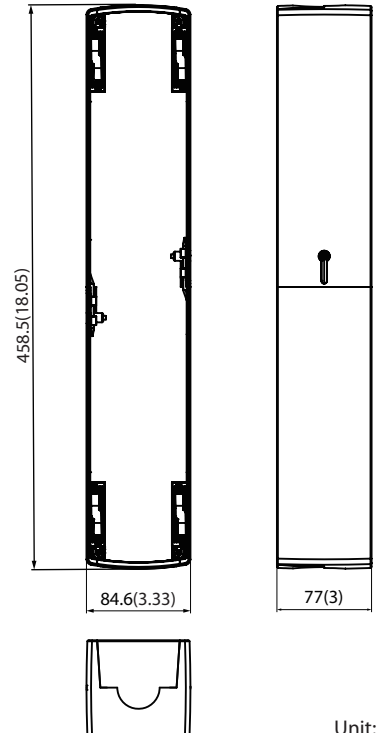

Unit:mm(inch)

OPTEx CO., LTD. (JAPAN)
(ISO 9001 Certified)
(ISO 14001 Certified)
5-8-12 Ogoto Otsu
Shiga 520-0101
JAPAN
TEL:+81-77-579-8670
FAX:+81-77-579-8190
URL:<http://www.optex.co.jp/e/>

OPTEx INCORPORATED (USA)
TEL:+1-909-993-5770
Tech:(800)966-7839
URL:<http://www.optexamerica.com/>

OPTEx (EUROPE) LTD. (UK)
TEL:+44-1628-631000
URL:<http://www.optex-europe.com/>

OPTEx SECURITY SAS (FRANCE)
TEL:+33-437-55-50-50
URL:<http://www.optex-security.com/>

OPTEx SECURITY Sp.z o.o. (POLAND)
TEL:+48-22-598-06-55
URL:<http://www.optex.com.pl/>

OPTEx KOREA CO., LTD. (KOREA)
TEL:+82-2-719-5971
URL:<http://www.optexkorea.com/>

OPTEx (DONGGUAN) CO., LTD. SHANGHAI OFFICE (CHINA)
TEL:+86-21-34600673
URL:<http://www.optexchina.com/>